

POLIGONO "B" JAIME PETER

DEPARTAMENTO ISCHILIN – PEDANIA TOYOS

Sup.= 32Ha 2.817 m²
Escala 1: 5.000

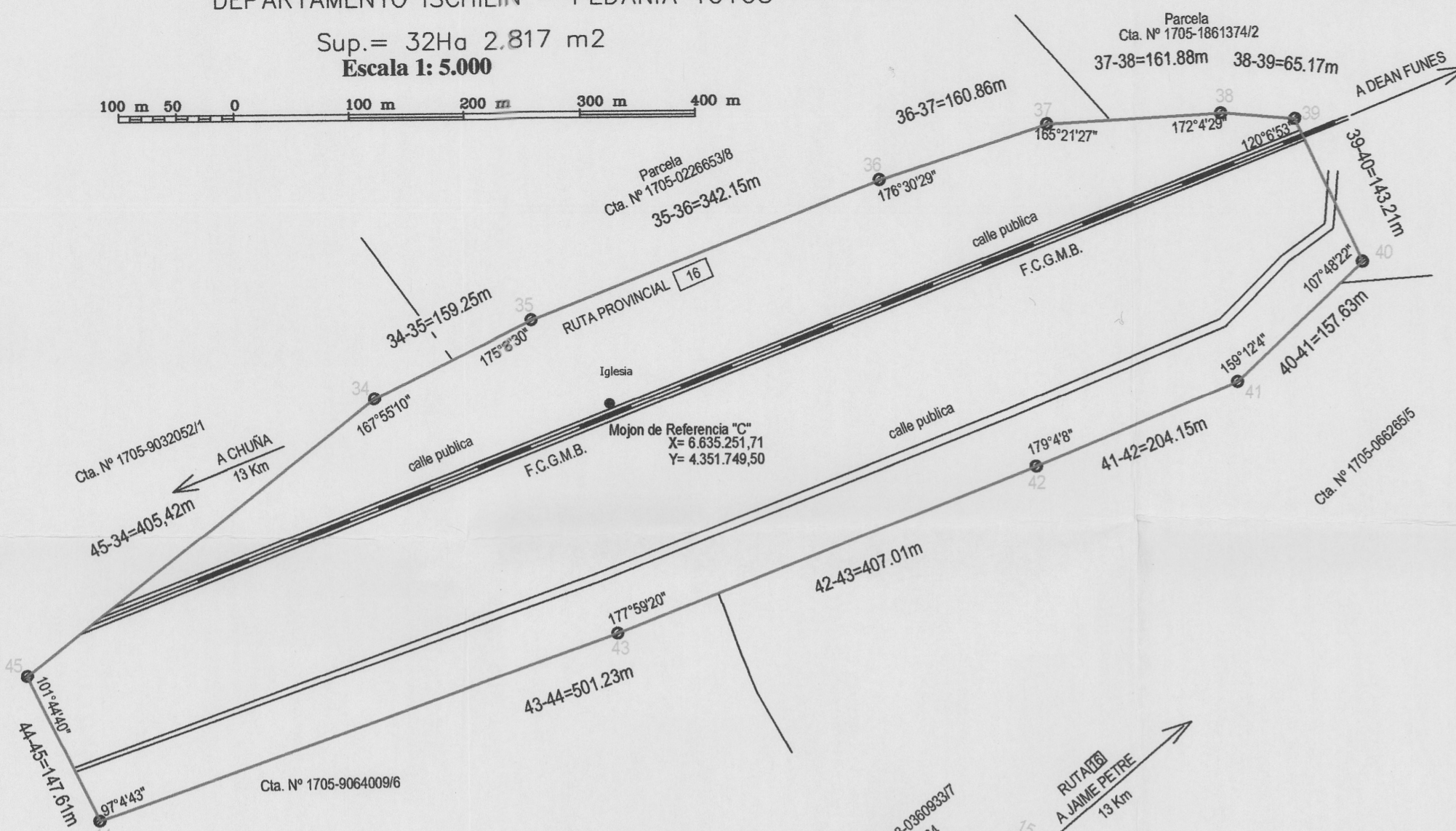
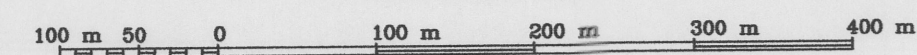

**COORDENADAS GAUSS KRUGER
POLIGONO CHUÑA**

1	X: 6.628.411,68	Y: 4.339.638,46
2	X: 6.628.438,91	Y: 4.339.578,04
3	X: 6.628.447,83	Y: 4.339.541,59
4	X: 6.628.466,07	Y: 4.339.504,73
5	X: 6.628.505,52	Y: 4.339.513,81
6	X: 6.628.504,84	Y: 4.339.534,59
7	X: 6.628.549,73	Y: 4.339.538,91
8	X: 6.628.584,57	Y: 4.339.534,07
9	X: 6.628.606,52	Y: 4.339.536,93
10	X: 6.628.758,55	Y: 4.339.168,99
11	X: 6.629.213,28	Y: 4.339.382,43
12	X: 6.629.116,78	Y: 4.339.589,19
13	X: 6.629.250,57	Y: 4.339.647,27
14	X: 6.629.850,87	Y: 4.340.114,46
15	X: 6.630.072,76	Y: 4.340.238,77
16	X: 6.630.049,28	Y: 4.340.274,15
17	X: 6.630.006,68	Y: 4.340.360,76
18	X: 6.630.001,69	Y: 4.340.391,45
19	X: 6.629.186,44	Y: 4.340.014,46

**COORDENADAS GAUSS KRUGER
POLIGONO CHUÑA**

20	X: 6.629.122,88	Y: 4.340.143,59
21	X: 6.629.034,38	Y: 4.340.101,78
22	X: 6.629.047,92	Y: 4.340.075,46
23	X: 6.628.958,01	Y: 4.339.999,26
24	X: 6.628.921,62	Y: 4.340.016,36
25	X: 6.628.918,66	Y: 4.340.029,56
26	X: 6.628.921,25	Y: 4.340.118,85
27	X: 6.628.914,95	Y: 4.340.146,84
28	X: 6.628.902,29	Y: 4.340.175,26
29	X: 6.628.856,93	Y: 4.340.246,21
30	X: 6.628.812,82	Y: 4.340.349,34
31	X: 6.628.720,00	Y: 4.340.391,92
32	X: 6.628.273,53	Y: 4.340.201,30
33	X: 6.628.508,50	Y: 4.339.683,09

**COORDENADAS GAUSS KRUGER
POLIGONO JAIME PETER**

34	X: 6.635.262,88	Y: 4.351.536,79
35	X: 6.635.333,10	Y: 4.351.679,71
36	X: 6.635.457,44	Y: 4.351.998,47
37	X: 6.635.506,66	Y: 4.352.151,62
38	X: 6.635.515,63	Y: 4.352.313,25
39	X: 6.635.510,23	Y: 4.352.378,20
40	X: 6.635.380,83	Y: 4.352.439,54
41	X: 6.635.272,98	Y: 4.352.324,58
42	X: 6.635.195,62	Y: 4.352.136,62
43	X: 6.635.046,51	Y: 4.351.756,96
44	X: 6.634.879,80	Y: 4.351.284,26
45	X: 6.635.011,90	Y: 4.351.218,39

UBICACIÓN

ESCALA 1 : 100.000

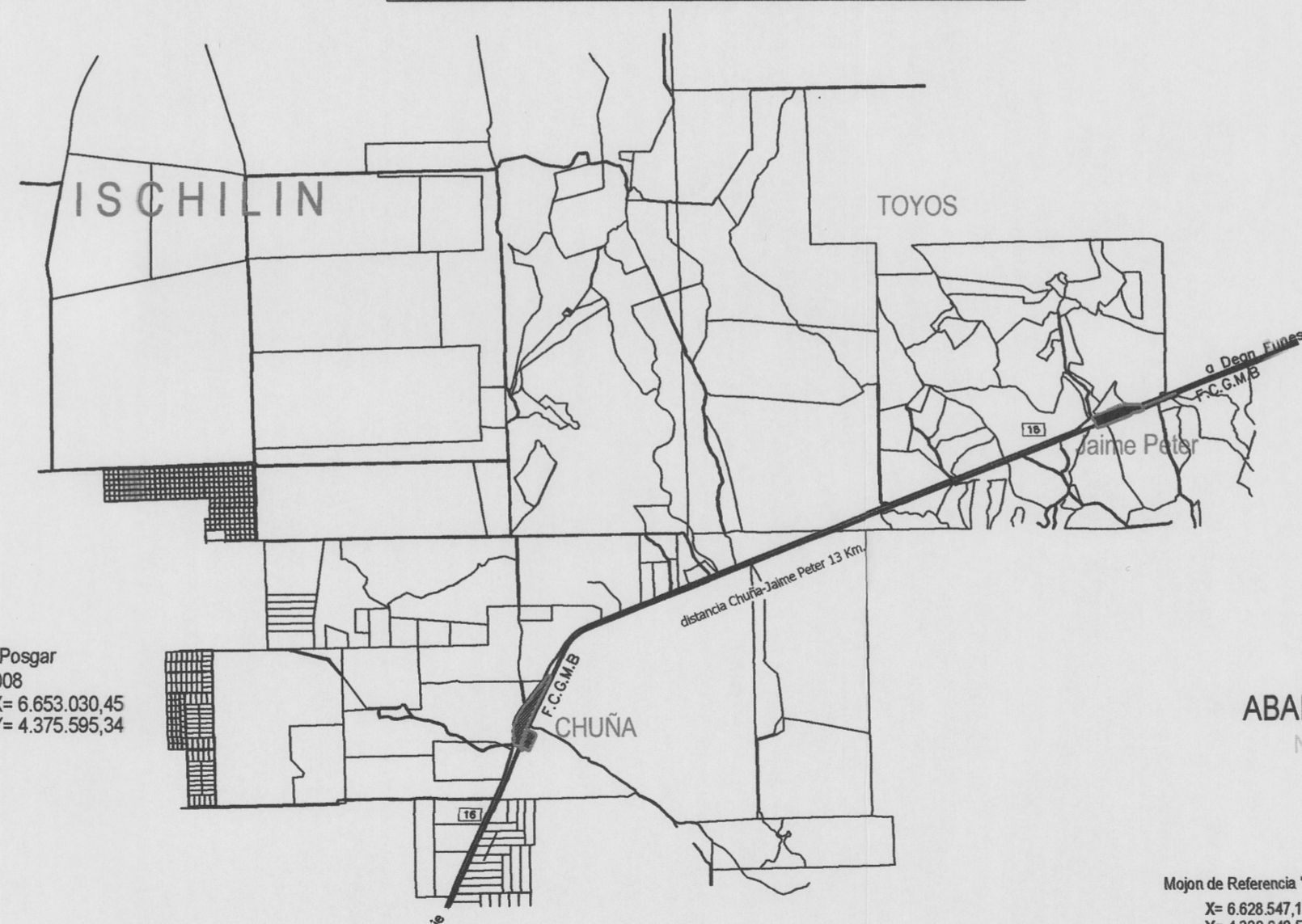

POLIGONO "A" CHUÑA

DEPARTAMENTO ISCHILIN – PEDANIA TOYOS

Sup.= 92Ha 9.199 m²
Escala 1: 7.500

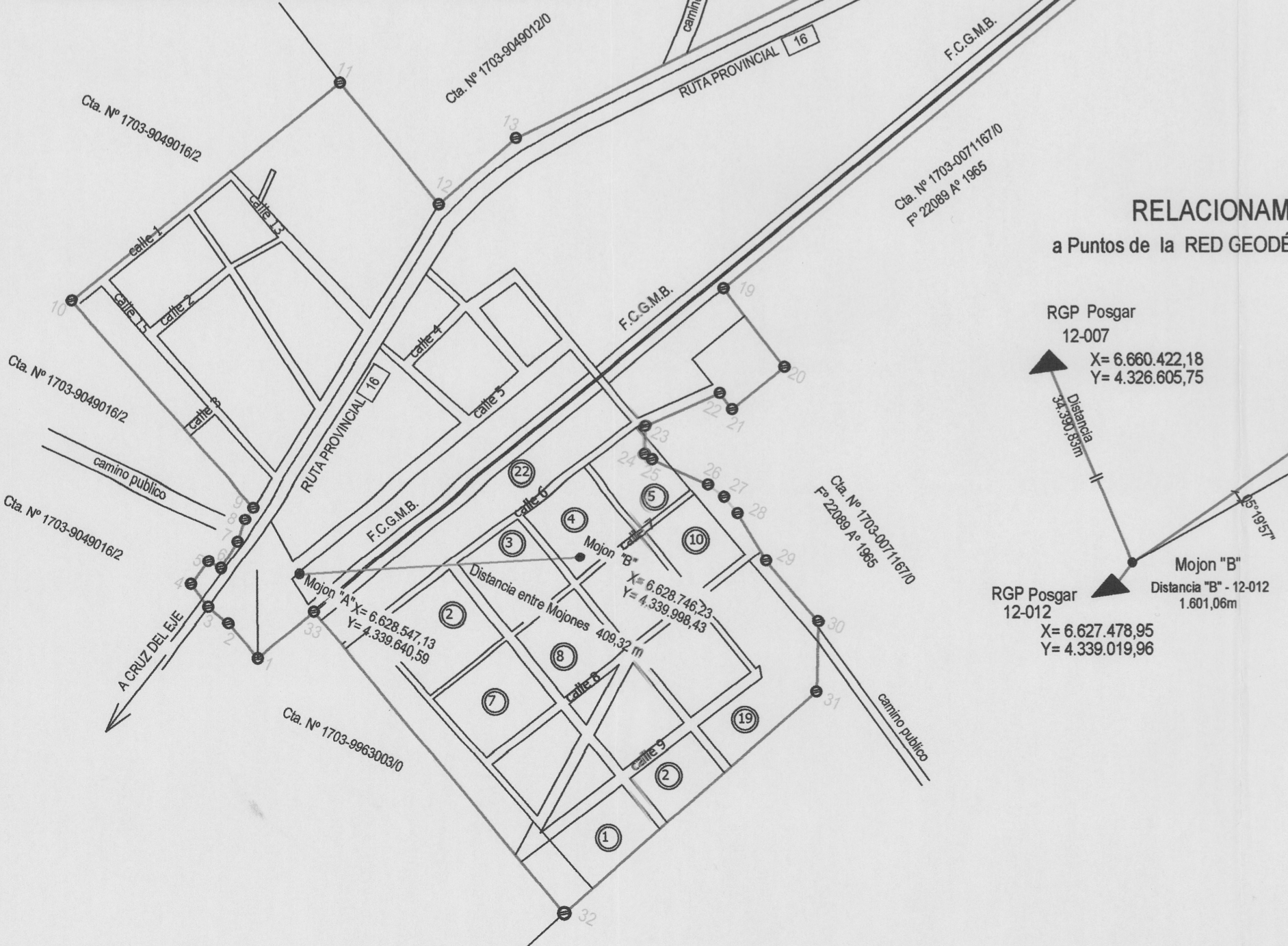
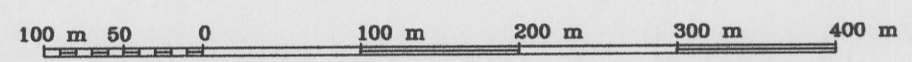

RELACIONAMIENTO

a Puntos de la RED GEODÉSICA PROVINCIAL

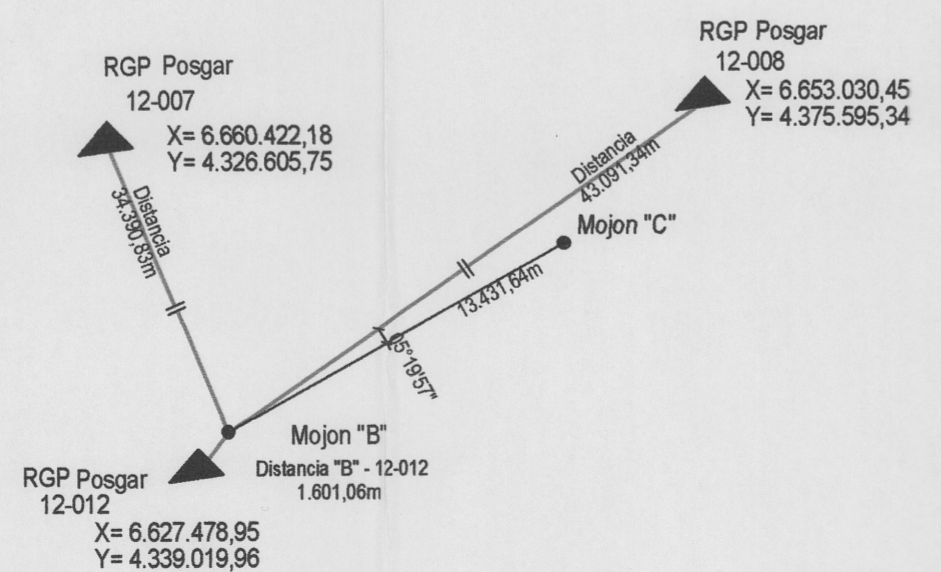

**PLANILLAS DE ANGULOS Y LADOS
POLIGONO CHUÑA**

Vértice	Angulo	Lado
01	90°28'55"	254.33 m
02	190°30'35"	42.46 m
03	167°25'20"	96.52 m
04	103°22'45"	31.09 m
05	101°04'00"	898.19 m
06	266°23'18"	143.93 m
07	193°23'59"	97.88 m
08	164°39'41"	29.60 m
09	254°59'04"	117.86 m
10	87°18'23"	40.20 m
11	90°07'23"	13.53 m
12	271°33'16"	89.33 m
13	165°34'26"	28.69 m
14	188°38'01"	31.11 m
15	85°41'35"	254.33 m
16	187°22'37"	42.46 m
17	196°50'23"	96.52 m
18	74°25'55"	31.09 m
19	268°36'41"	898.19 m
20	90°54'58"	143.93 m
21	88°03'26"	97.88 m
22	256°57'06"	29.60 m
23	245°27'05"	117.86 m
24	232°11'45"	40.20 m
25	194°17'35"	13.53 m
26	165°39'18"	89.33 m
27	168°40'26"	28.69 m
28	171°25'05"	31.11 m

**ABALIZAMIENTO
Mojon "A"**

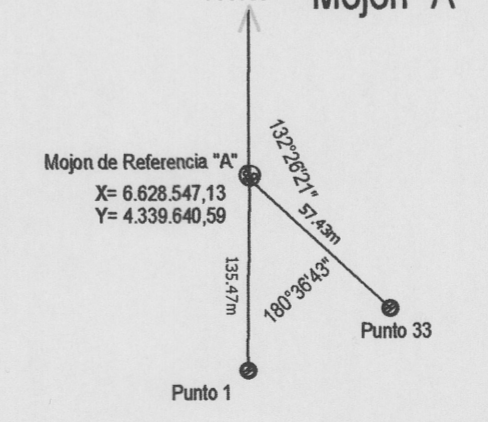

**ABALIZAMIENTO
Mojon "C"**

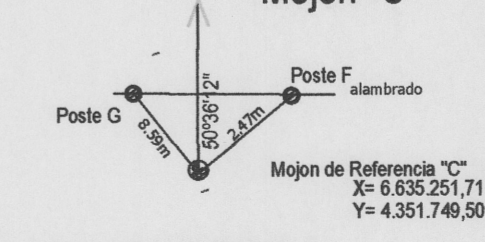

**UBICACION: Plano radio COMUNAL
en Hojas Registro Grafico**

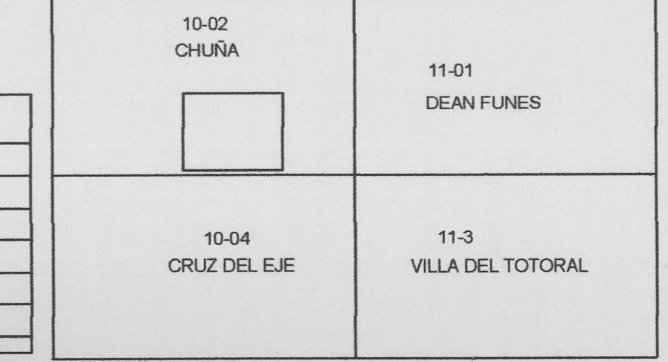

REGISTRO DE SUPERFICIES

Poligono	Superficie	Observaciones
CHUÑA	92 Has 9.199 m ²	
JAIME PETER	32 Has 2.817 m ²	
Σ	125 Has 2.016 m ²	

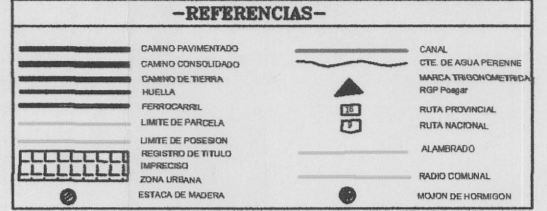

**PLANILLA DE RUMBOS
POLIGONO CHUÑA**

Vértice	RUMBO
01	335°44'
02	346°15'
03	333°40'
04	257°03'
05	178°07'
06	264°30'
07	277°54'
08	262°34'
09	337°33'
10	244°51'
11	154°59'
12	246°32'
13	232°06'
14	240°44'
15	146°26'
16	153°49'
17	170°45'
18	65°11'
19	333°48'
20	244°43'
21	152°46'
22	229°43'
23	295°10'
24	347°22'
25	01°40'
26	347°19'
27	335°59'
28	317°24'
29	336°51'
30	294°38'
31	246°53'
32	155°37'
33	65°15'

RADIO COMUNAL

Localidad: **Comuna de CHUÑA**

UBICACION

Departamento: **17 ISCHILIN** Pedanía: **03 COPACABANA** Localidad: **06 CHUÑA**

PUNTOS AMOJONADOS

NOMBRE	NORTE	ESTE
Mojón A	X= 6.628.547,13	Y= 4.339.640,59
Mojón B	X= 6.628.746,23	Y= 4.339.998,43
Mojón C	X= 6.635.251,71	Y= 4.351.749,50

Observaciones: El límite del Radio comunal fue determinado a partir de mojones existentes originales de los loteos que componen la Comuna.
AWEXOT = Resolución N° 240/2022.

FIRMAS
Torres Estela Mariela (Tesorera Comuna de Chuña)
Ing. Agrim. Mat. Prof. 1259-1
Ing. Agustín GUSTAVO M. GARCÍA (Director General Dirección General de Catastro)
Ing. Agrim. - Mat. Prof. 1259-1

PROFESIONAL
STEVENAZZI GERARDO FABIAN
 ING. AGRIMENSOR
 M.P. 1259/1

FECHAS Y FIRMAS DE VISADO
 EXPTE.: 0423-032100-2008
 SEGUIN INFORME: 20/2022